

| KEY | | GRADING & DRAINAGE LEGEND | |
|-----|--|---------------------------|---|
| | Existing tree to remain | | Existing contour shown at 1'-0" intervals. |
| | Proposed contours shown at 1'-0" intervals | | Proposed spot elevation |
| | Flow line of drain pipe. | | Grate Elevation |
| | Gradient of drain line | | Property Line |
| | Drain Line: Class 3 transite storm drain line (2000 lbs. crush load). Size as indicated on plan. | | Curb basin: 5D no. 12 with a slotted, 24" x 48" M.H. cover. SCS and specifications. |
| | Existing spot elevation | | Detail no. |
| | Sheet no. | | Drainage swale center line and direction of flow. |
| | Existing joint pole. | | |
| | New paving, see "Paving and Lighting Plan" | | Drinking fountain, see "Sprinkler Irrigation Plan" |
| | Manhole: 5D no. 13 SCS and specifications. | | |

- Notes:**
- Existing contours are based on information received from Cartwright Aerial Surveys Inc. date of photography 2-7-68.
 - Existing drain line location is based on information received from Sutcliffe and Marrow, plan - Olympic Way (cul-de-sac) dated 5-31-72, sheet 2 of 2.
 - This project does not require the importation or exportation of topsoil.
 - Any additional soil shall be left on site in a designated area as indicated on plan. The stockpile area shall be left in a smooth appearance.
 - Prior to any trenching, the contractor shall verify the location of all existing underground utilities.
 - Install cleanouts on drain line at all changes of direction or at 100' intervals along straight lines. See detail below.

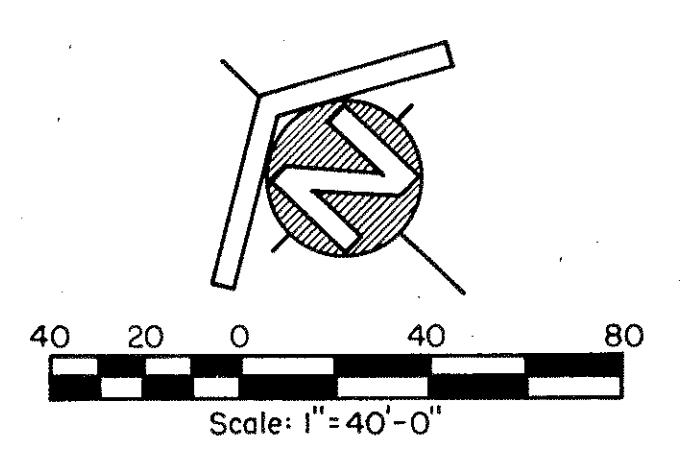
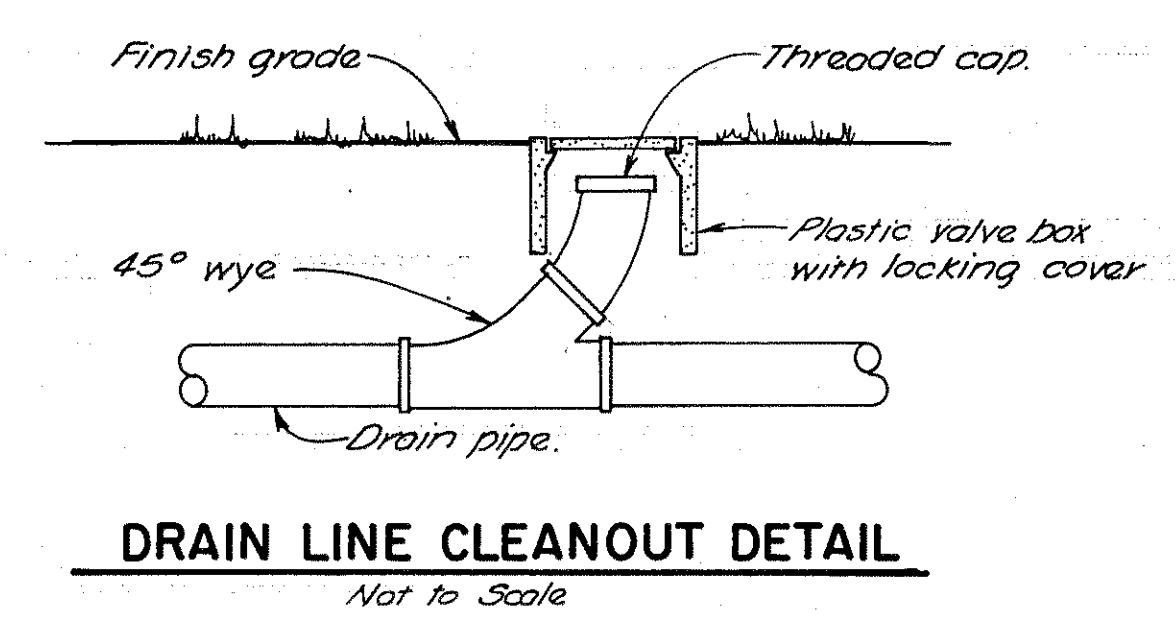

REFERENCE POINT
Bench mark: SAC. CO. # 8-31 elev. 12707
7/8" metal disc located in top of curb.

Dennis R. Torri 1076

Consultants

SPRUCE PARK
Sunrise Recreation and Park District
Sacramento County



Dennis Tsuboi & Associates
Landscape Architecture and Environmental Planning
4215 Freeport Boulevard
Sacramento, California
Phone: (916) 452-4205

| Sheet title | | |
|---------------------------|----------|---------|
| GRADING AND DRAINAGE PLAN | | |
| Design | Date | Revised |
| CM | 12-10-76 | |
| CM | 12-15-76 | |
| DT | 1-28-77 | |
| Approved | | |

Sheet
Of
11 (15)

P2560-P2560-03-02 OF 11_01